

Ground Floor Plan

AEGEAN

APARTMENT 16

Living/Dining	17' 2" x 15' 0"	5.24m x 4.58m
Kitchen	17' 2" x 7' 6"	5.24m x 2.30m
Master Bedroom	13' 8" x 15' 8"	4.16m x 4.78m
Bedroom 2	12' 5" x 9' 2"	3.80m x 2.80m

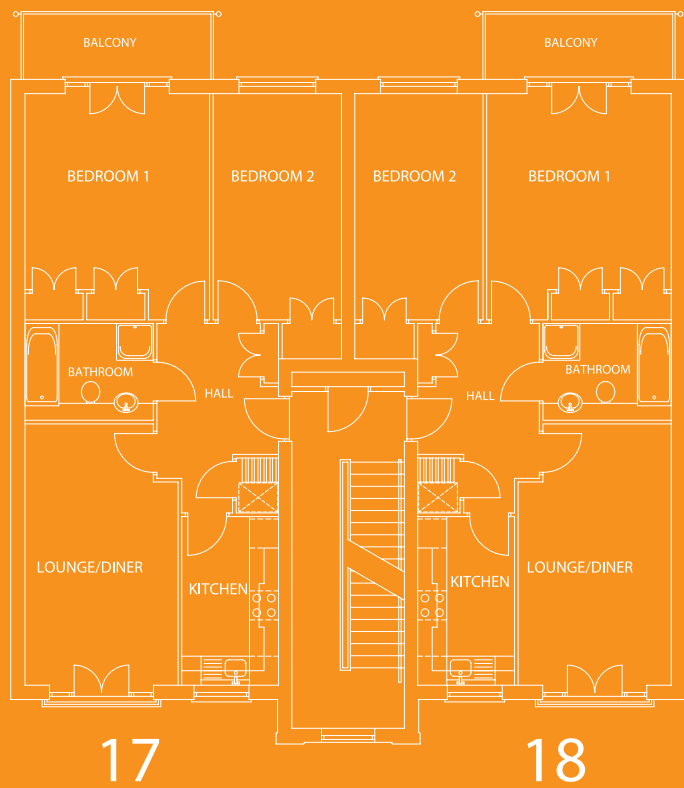

First Floor Plan

AEGEAN

APARTMENTS 17-18

Living/Dining	17' 9" x 10' 4"	5.40m x 3.16m
Kitchen	11' 5" x 6' 7"	3.48m x 2.00m
Master Bedroom	15' 4" x 12' 6"	4.67m x 3.81m
Bedroom 2	15' 4" x 8' 8"	4.67m x 2.65m



SECOND FLOOR

These details are intended to give a general indication of the proposed development and floor layouts. The company reserves the right to alter any part of the development specification or floor layout at any time. The contents herein shall not form part of any contract or be a representation inducing any such contract. These properties are offered subject to availability. Applicants are advised to contact the developers agent to ascertain the availability of any particular type of property so as to avoid a fruitless journey. Please note that the floor plans are for guidance purposes only and should not be used for carpet/curtain sizes. All bedroom measurements include wardrobe depth where applicable.

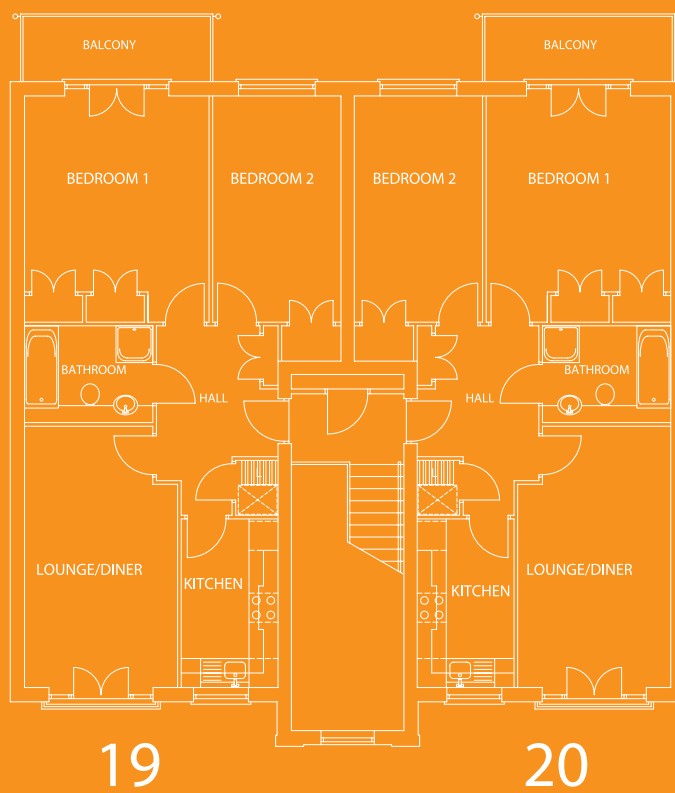

Second Floor Plan

AEGEAN

APARTMENTS 19-20

Living/Dining	17' 9" x 10' 4"	5.40m x 3.16m
Kitchen	11' 5" x 6' 7"	3.48m x 2.00m
Master Bedroom	15' 4" x 12' 6"	4.67m x 3.81m
Bedroom 2	15' 4" x 8' 8"	4.67m x 2.65m



AEGEAN